



Chrome Profile and Extensions (Students)

Overview

By logging into the Chrome browser, you can customize your Chrome browsing experience. Once logged into the Chrome browser, you can add extensions, which are small software programs that enhance your Chrome functionality.

Sign-in to Chrome

To install Chrome extensions, you need to be signed in to your Chrome profile. If you are working on a Chromebook, you will be automatically signed in to your District Chrome profile. If not, follow these directions to sign in to Chrome.

1. Open **Chrome**.



2. Click on the **profile icon**.



3. Select **Turn on sync...**

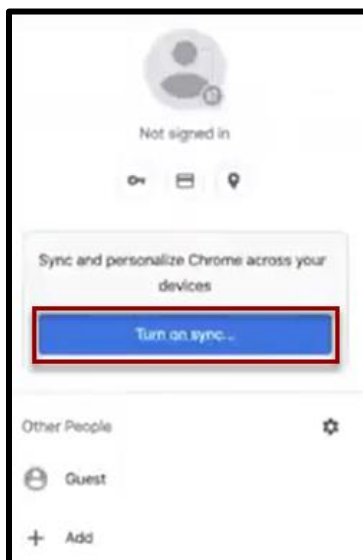

4. Enter your **FWISD Google username** and click **Next**.

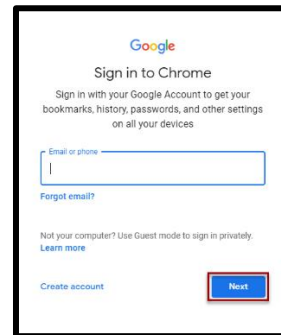

Note: Your Google username is the letter s followed by your student ID number @students.fwisd.org.

Example: s123456@students.fwisd.org

5. Enter your **FWISD username** on the next screen and click **Next**.

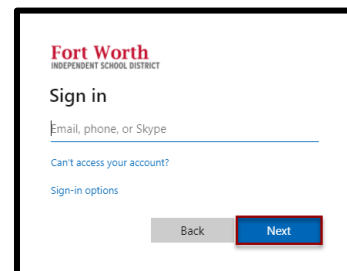

Note: For students, this is letter s followed by your student ID number @stu.fwisd.org.

Example: s123456@stu.fwisd.org

6. Enter your **password** and click **Sign in**.

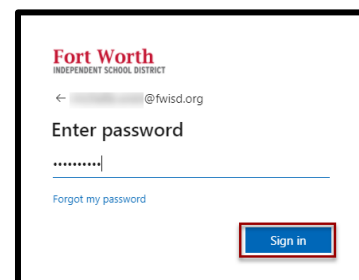



Chrome Profile and Extensions (Students)

7. Click Continue at the verification window.

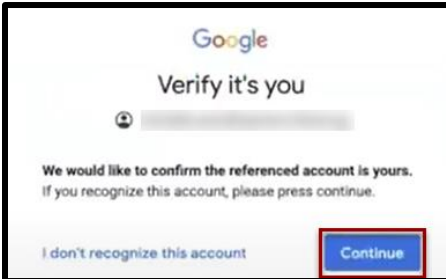

8. If prompted, select Link Data.

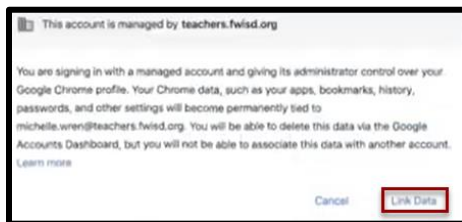

9. If prompted, select Yes, I'm in.

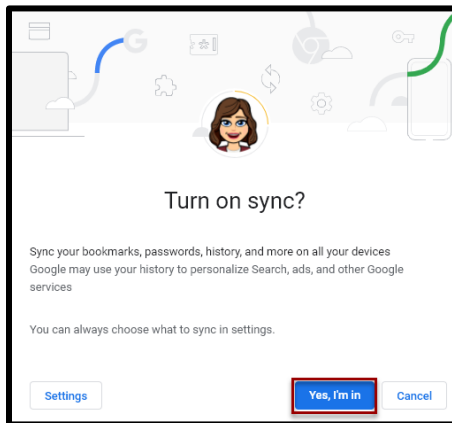

Installing Extensions

1. Open Chrome.



2. Navigate to the [Chrome Web Store](https://chrome.google.com/webstore/category/extensions).
<https://chrome.google.com/webstore/category/extensions>

3. Enter your extension name in the Search the store box. You can search by Categories as well.

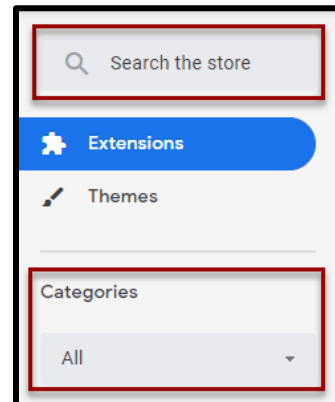

4. Click on the title to learn more about the extension. To return to the extension home page, click back arrow, or Extensions as shown.

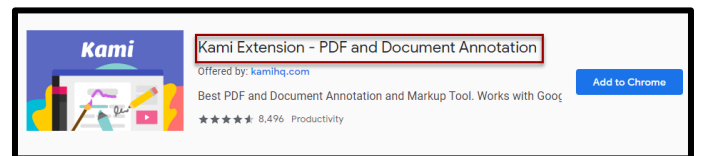

5. Click Add to Chrome to install an extension. Some extensions will let you know if they need certain permissions or data. To approve, click Add extension in the pop-up window.

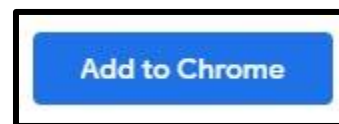

6. To use an extension, click the icon to the right of the address bar.





Quick Reference Guide

Chrome Profile and Extensions (Students)

Manage Extensions

1. In an open Chrome browser, click More.

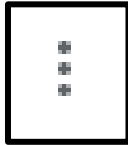

2. Click More Tools.

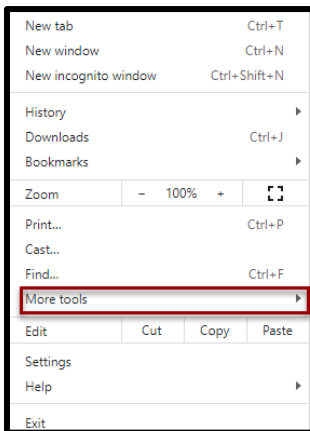

3. Click extensions.

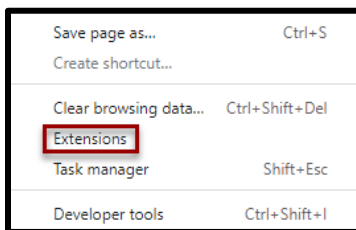

4. To turn an extension on or off, toggle the on/off button as shown.

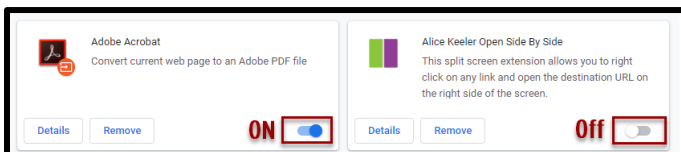

5. To uninstall an extension, click Remove.

